

GRAN POLE STAND Instruction Manual

Package content

Pole

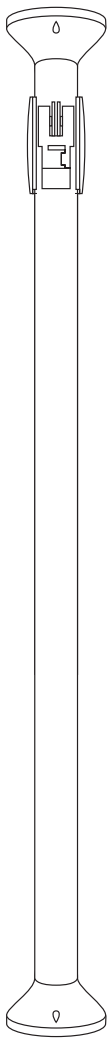

Holder

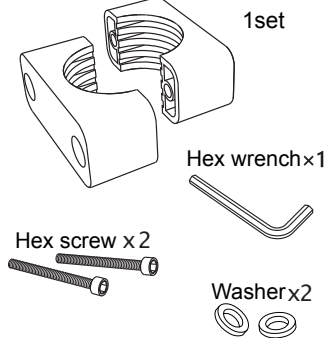
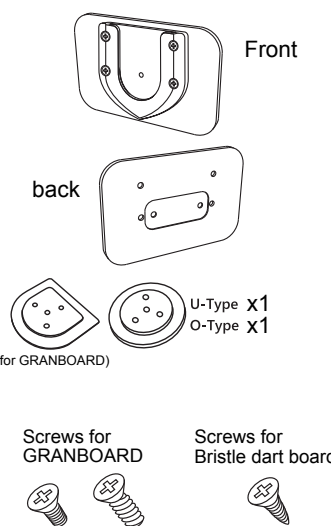
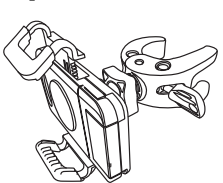

Plate and Bracket



Smartphone Holder



Cushion material

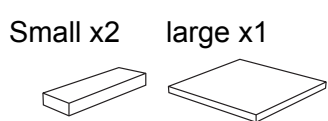

Hold tool and Cover

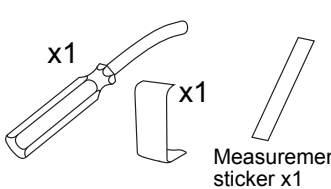

How to assemble the pole and holder

1

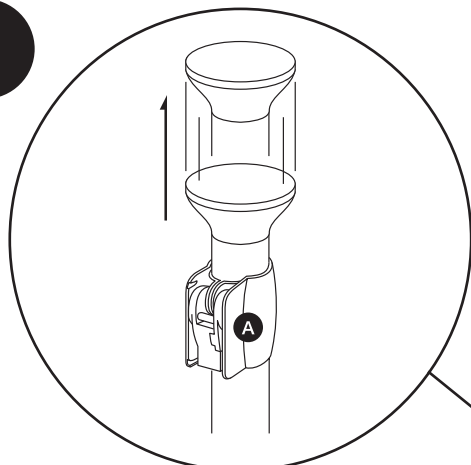

Slide the top part of the pole and extend it to the ceiling, and hold it by hand. When installing along a wall, install part **A** so that it faces the wall. (Refer to the completed drawing)

2

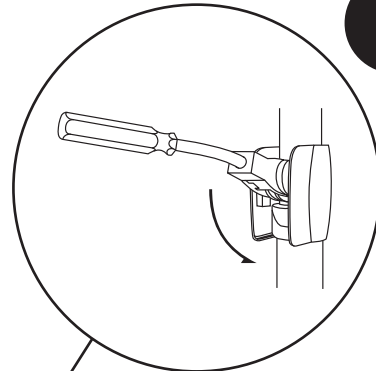

While firmly holding the pole extended to the ceiling, use the hold tool to insert the tool as shown and pull it down from the top to fix the pole.

4

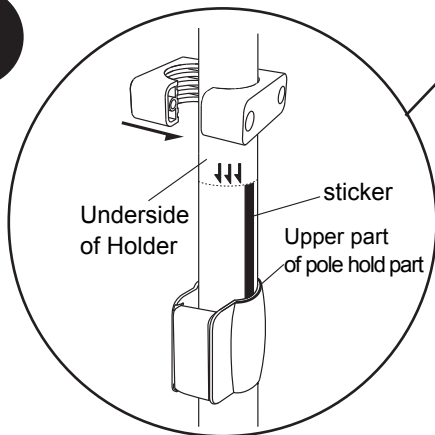

Stick the included measurement sticker on the upper side of the pole hold part in the center. Set the Holder according to the measurement sticker.

3

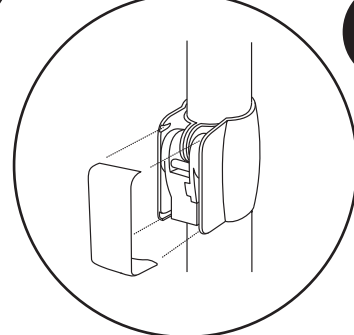

After fixing the pole firmly, attach the cover.

5

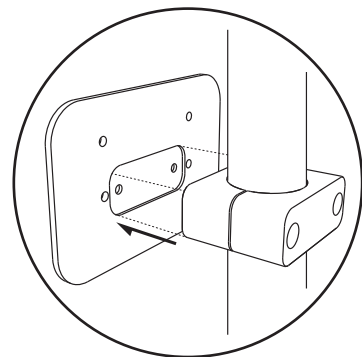

Align the holder firmly with the groove in the plate.

6

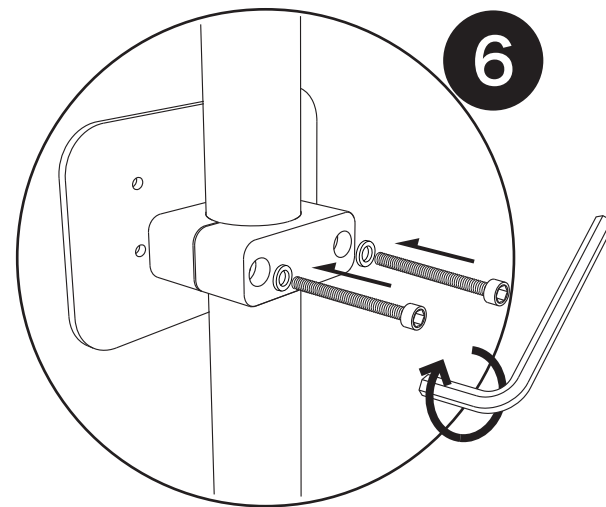

Attach the hex screws through the holder to the plate. Use an hex wrench to tighten left and right alternately little by little. ※Be sure to attach a washer.

How to attach the smartphone holder

After firmly sandwiching the part of the smartphone holder that is sandwiched between the poles, turn the knob to the right and fix it so that the holder does not fall from the pole.

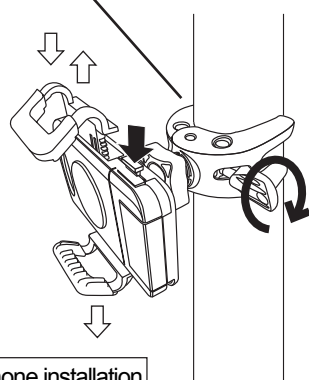

Smartphone installation

When you press the button of ↓, the upper and lower hold parts ↓ will open automatically, so if you put your smartphone there, return the open hold part by hand and fix it so that it does not fall.

How to install the bracket

Board side

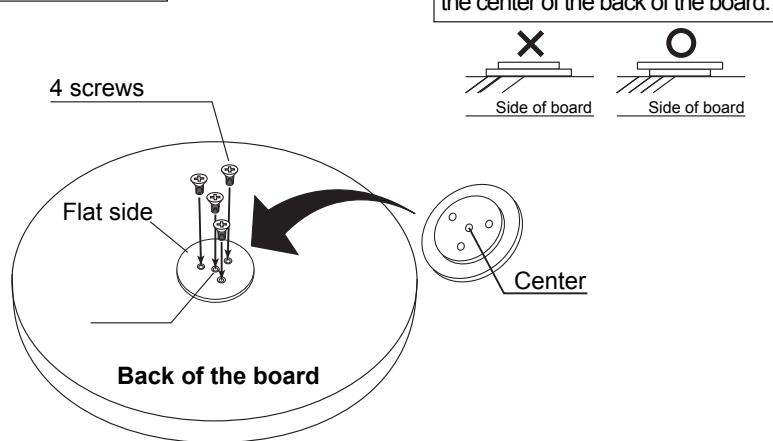

Be sure to attach it to the board with the specified screw. Using a different screw may cause an unexpected accident or board failure.

Installation of cushion material

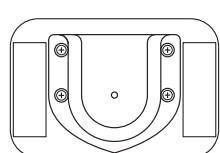

Since there is a gap between the board and the plate, attach the cushion material to the plate.

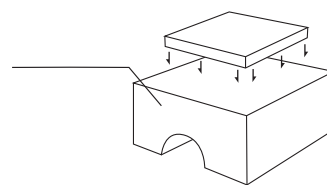

The cushioning material (large) can be attached to one of the Styrofoams that is packed in the package and attached between the pole and the board to reduce the vibration of the board when throwing darts.

Complete image

Front

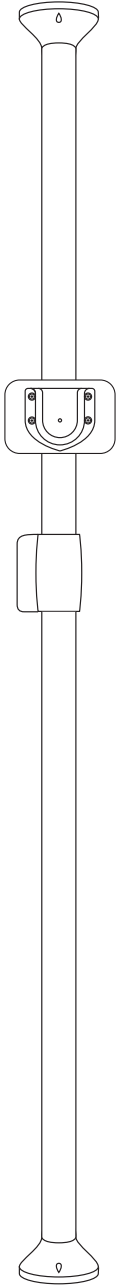

Side ceiling

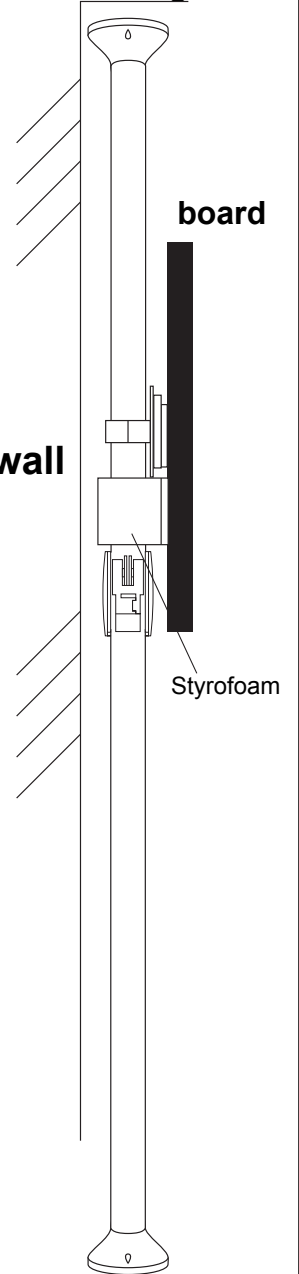

組み立て上のご注意

- Before assembly, please make sure that all parts and components are included.
- Be sure to assemble two or more people on the pole stand to prevent accidents.
- Be sure to work on a flat surface. Also, do not install in a place that is difficult to fix, such as a place with a soft floor or ceiling or a place that is not horizontal.
- Assemble the product on a floor with cloth or carpet, and be careful not to damage the product, the floor, walls, or surrounding furniture.



The board is heavy and should be handled with care. If you install it incorrectly, the board may drop, so be sure to check the installation method carefully. Also, do not throw darts at anyone as it is dangerous.